

AVAILABLE



For Lease
634 W. Charles Street
(Former Electrolux Facility)
Greenville, MI



401 Hall Street SW
Grand Rapids, MI 49503
616-243-9000
616-243-1013/fax

OFFERING SUMMARY DETAIL

PROPERTY INFORMATION

Brief Description: This is one of the finest warehouse/distribution facilities available in West Michigan. Extensive exterior truck dock loading and truck staging area. Interior rail spur for ten cars, air rotation unit, fully sprinkled at .3 GPM/2,000 SF, 28' clear height with 40' x 50' column spacing. The industrial buildings towards the river are scheduled for future demolition.

Address: 634 W. Charles Street, Greenville, MI 48838

County: Montcalm

Property Location: 40 miles northwest of Grand Rapids

Cross Streets: M-91 and Charles Street

Proximity To: US-131: 17 miles M-57: 1 mile M-91: 1/2 mile

Directions To Property: US-131 north to M-57, east to M-91, north to W. Charles Street, west to property

Zoning: Industrial

Neighboring Properties: Residential and Industrial

GENERAL BUILDING INFORMATION

Total Building SF: 442,420

Available SF: 442,420

Manufacturing/Warehouse SF: 437,420

Office SF: 5,000

Acreage|Lot Size: 21.22 acres

Year Built: 1981

Construction: Pre Engineered Steel with a 10' Concrete Block Knee Wall



401 Hall Street SW
Grand Rapids, MI 49503
616-243-9000
616-243-1013/fax

GENERAL BUILDING INFORMATION, CONT.

Floors Thickness:	8" reinforced
Roof:	Rubber Membrane
Sprinklered:	Wet System - .3 GPM/2,000 SF
Security System:	No
Driveway Surface:	Asphalt and Concrete
Parking Spaces:	Ample

UTILITIES

Water Sewer:	City of Greenville
Gas:	DTE Energy
Electric:	Consumers Energy
Telephone:	Ameritech

MANUFACTURING/WAREHOUSE SPECIFICATIONS

Manufacturing/Warehouse SF:	437,420
Ceiling Height:	28 ft. clear height
Lighting:	Sodium Vapor and Metal Halide Fluorescent Task lighting in hi-lo charging area
Levels:	One (1)
Lavatories:	Two (2)
Power - AMPS:	1,000 amps (after disconnection from other property)
Power - VOLTS:	440 volts
Heat:	Air Rotation and Unit Heaters - Gas/Forced Air Radiant Heat near Rails
Column Spacing:	40' x 50'
Grade Doors (# and Size):	One (1) - 12' x 14'
Truck Docks (# and Size):	Twenty-three (23) - All with levelers, seals and chock locks - 9' 2" x 10'



401 Hall Street SW
Grand Rapids, MI 49503
616-243-9000
616-243-1013/fax

MANUFACTURING/WAREHOUSE SPECIFICATIONS, CONT.

Dimension Between Docks:	13' 5"
Concrete Dock Apron:	60'
Railroad:	Yes, Mid-Michigan Railroad/Rail America 750' of interior rail, dock high loading level
Outside Storage:	Yes
Airlines:	No
Floor Drains:	No

OFFICE SPECIFICATIONS

Office SF:	5,000 +/-
Private Offices:	Three (3)
Break Room:	Yes, upstairs
Kitchenette:	Yes
HVAC:	Yes
Levels:	One (1) with small mezzanine over office

Lease Terms:	36 - 60 months
Lease Type:	Triple Net
Possession:	At lease execution
Tenant Improvement Allowances:	None but negotiable
Other Conditions:	Subject to lessor's approval of lessee's use and financial condition.
Lessor Pays:	Structural and roof
Lessee Pays:	Pro rata share of all operating expenses, including, but not limited to: taxes, insurance, utilities, mechanical systems maintenance and repairs, building and grounds maintenance and snow removal. Lessee responsible for their own utilities as well.



401 Hall Street SW
Grand Rapids, MI 49503
616-243-9000
616-243-1013/fax

For additional information or to arrange a showing of this unique industrial facility, please contact:

**Rick Ford
ANYI Property Services/Delta Properties
401 Hall Street SW
Suite 108
Grand Rapids, MI 49503**

**616-243-9000/phone
616-243-1013/fax**

All data contained herein is believed reliable but no responsibility or liability is assumed for accuracy by ANYI Property Services/Delta Properties or any of its agents or representatives. Information is subject to verification. Price and terms are subject to change.

634 Charles St

Greenville, Michigan
(Former Electrolux)

PRIME Manufacturing Distribution & Storage



23 Dock Doors



30' ceiling height
40 x 50 bays



Rail Siding

LEASE RATE ONLY

\$1.25 per sq ft

NNN + util. extra

CALL Rick Ford
ANYI Property Services LLC
(616) 243-9000



401 Hall Street SW
Grand Rapids, MI 49503
616-243-9000
616-243-1013/fax

Survey/Drawings

WAREHOUSE FLOOR PLAN

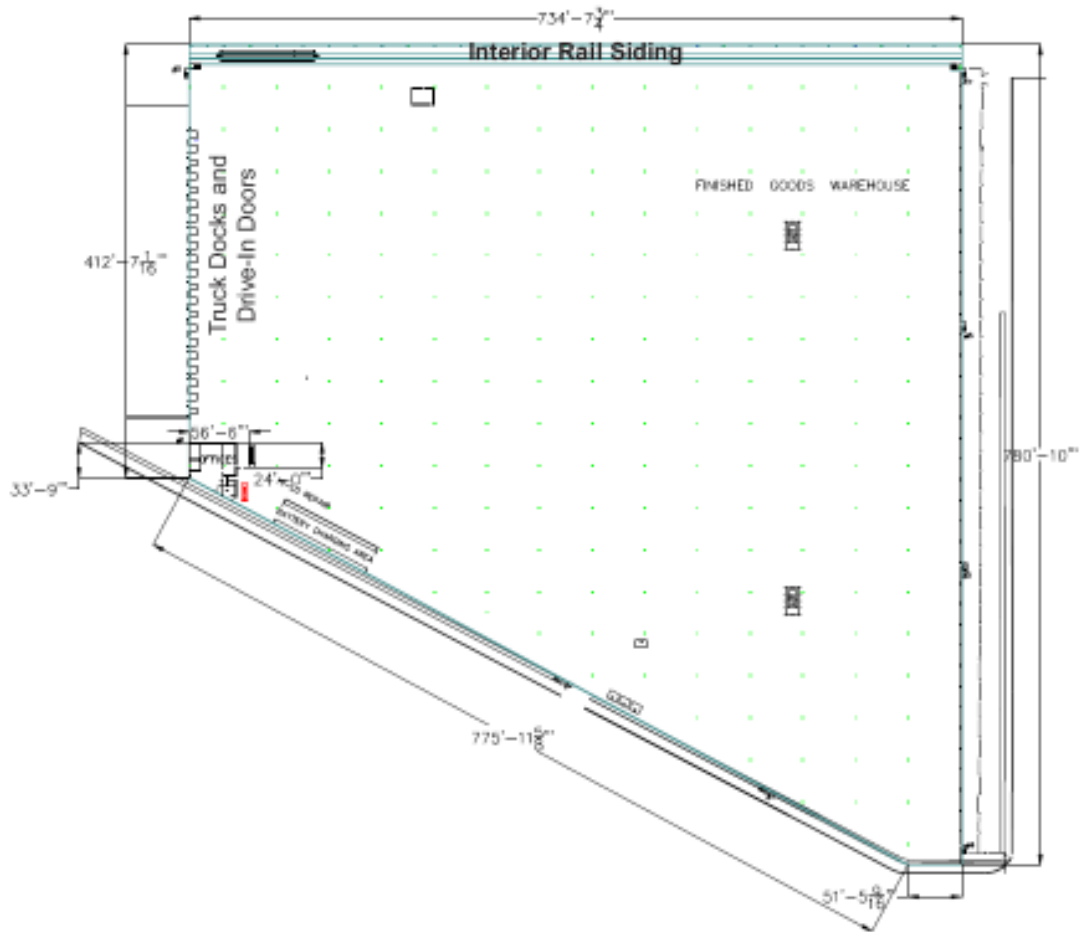

RAIL ELEVATION PLAN - NORTH END DETAILS

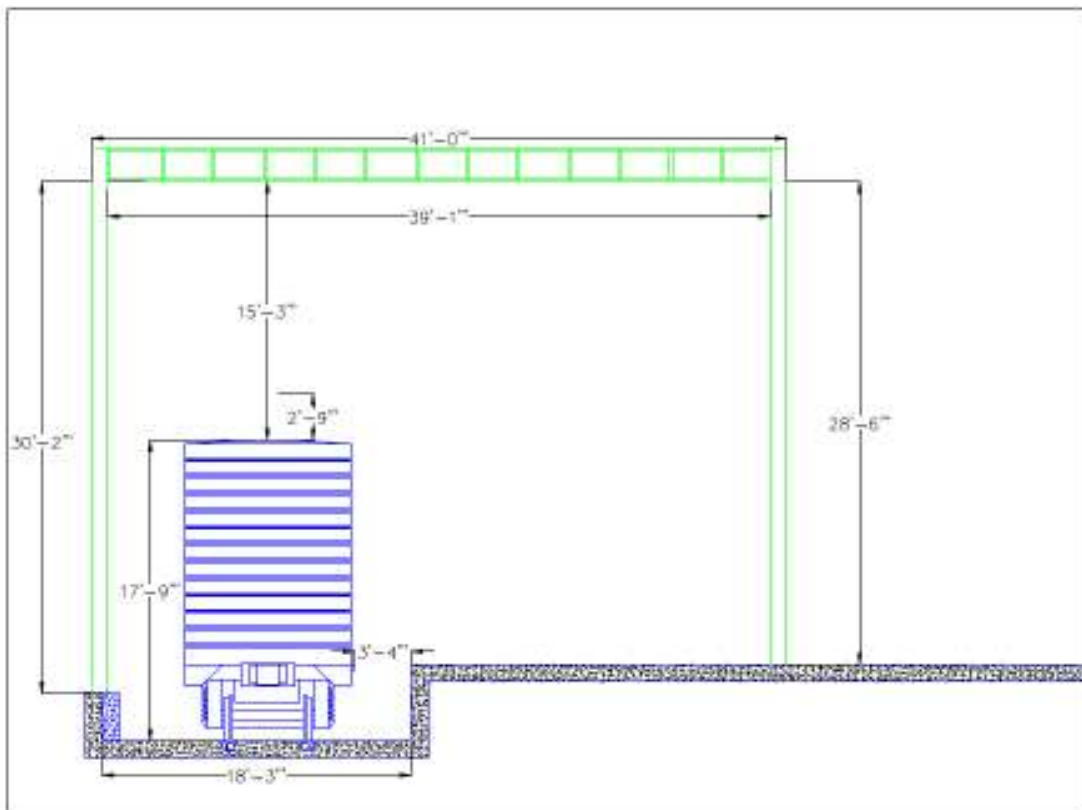

ANYI PROPERTY SERVICES LLC

401 Hall Street SW
Grand Rapids, MI 49503
616-243-9000
616-243-1013/fax



401 Hall Street SW
 Grand Rapids, MI 49503
 616-243-9000
 616-243-1013/fax

Street Map



West Michigan



Michigan

